



LA CROSSE COUNTY
Exceptional services. Extraordinary place.

**FAMILY
MEETING
TOWN HALL
July 17, 2024**

AGENDA

- Housekeeping items
- Introductions
- Campus updates
- Hillview Project update
- Next Steps
 - RFP/Bids
 - Board consideration
 - Construction Timeline
 - Transitions

Project
Update

Timeline

Phases

Plans for each phase

Next Steps

- Bids come back July 25th.
- Board consideration of bids August 15th.
- Project **timeline**: approximately 18 months from start of construction.
- ******timeline of phases is a working document and will change.

Outdoor Prep Work will begin 9/24/2024 with goal to complete by 10/14/2024

- ▶ East side of the FRONT ENTRANCE; adding cement path for an emergency exit.
- ▶ 100 hall's new entrance for the CBRF -new paved path from new entrance to parking lot.
- ▶ New Patio between 300 and 400 hallways, back employee entrance, areas in back by the grease receptor, and another emergency exit in back
- ▶ All residents will still be able to use the front entrance to enter/exit. Just know there will be utility trucks/cement trucks in the vicinity and parking area if you wander towards the pond or walking paths. We will have areas flagged as “work zones” that need to be avoided.

RELOCATION OF SPACES-

- ▶ A new laundry room upstairs versus in the basement! This will be part of phase 1 when demo begins on east, the laundry room will also be constructed on west (back hall across from Rec Room)
- ▶ Temporary location for Karlie and Sue will be the old RESTORATIVE ROOM-end of 600 hall, first room on right when you walk down 600 hall from the front door.
- ▶ New laundry will be relocated to the space across from the Rec Room (Karlle & Sue's current office).
- ▶ We will have 4 washers and 4 dryers. Will continue with laundry services as is for now.
- ▶ Restorative Equipment has already been relocated to the RECREATION ROOM.

WHY NOW? We need to do what we can now, as there will be a lot going on when construction starts. We want to focus on the people, (the residents) as much as possible during other transitions.

9/23/2024-10/24/2024

- ▶ Construction begins on EAST HALLS
- ▶ Back hallway where laundry room will be going will have a temporary wall installed
- ▶ Basement HVAC construction
- ▶ Contactors walk through

- ▶ No access to East Hallways; This will be a construction zone.
- ▶ The corridor will be temporarily reduced. A temporary film/wall will be installed and will maintain 44" clearance down the corridor for egress.
- ▶ May cause some noise upstairs for residents, mostly some vibrations going through wall partitions.
- ▶ Trying to forecast and identify issues proactively. Walk through already occurred but there may be some stragglers.



Everyone will be impacted by this remodel

- ▶ New windows in every room
- ▶ New HVAC system in every room including resident rooms
- ▶ New Hallway lighting
- ▶ New paint in every room
- ▶ Wallpaper removal on hallways
- ▶ New Nurse Call System-
- ▶ Every hallway will be worked on in phases, starting with the 900 hallway.
- ▶ 900 residents will be temporarily relocated to the 100 hallway
- ▶ Staff stabilized on 900 will relocate to the 100 hallway.
- ▶ We will create a chart area for staff up front (an office will need to be relocated)

Phases of SNF hallways-short term transitions

- ▶ 900 Hallway 11/29/2024 through 1/29/2025
- ▶ 800 Hallway 1/30/2025 through 03/26/2025
- ▶ 700 Hallway/Spa/Toilet Rooms 3/27/2025 through 5/21/2025
- ▶ DSU 100 Hallway 03/27/2025 through 09/03/2025
- ▶ 600 Hallway 05/27/2025 thought 12/05/2025

These areas will
overlap in the same
phase

Campus updates

- ▶ Family Newsletter- will not be mailing copies any longer. Please sign up for an email version. We will have a few laminated color copies at the front desk and each neighborhood (HVT, CH, SNF, State Only). B/W copy with new admission packets
- ▶ Rummage Sale August 22;
- ▶ HVT plans to offer RESPITE

RELOCATION PLANS - long term plan

- ▶ There will be an INDIVIDUALIZED plan for each person who lives at Hillview
- ▶ State requires when projects like this occur, we complete a RELOCATION PLAN, even if it is in our building.
- ▶ TEAM includes (Ombudsman, Relocation Specialist, Family Care representative, ADRC representative and HV representative and Resident/Family)
- ▶ Plan will involve continual weekly assessing of each resident's preference, needs, and funding. Purpose is to openly communicate so there are no surprises. Preferences and needs may change throughout this process.
- ▶ **Residents are our number one priority**

HILLVIEW HEALTHCARE CENTER- CBRF HOUSEHOLD AREA B / A.2 35 BEDS + CRISIS 4 BED - CORRIDORS



CEILING LIGHT

Satin Nickel Door Hardware



Flat Panel-Stained Wood Doors w/ Painted Frames and Trim



VB-1 Cove Wall Base



SCONCE

Accent Color Column Bump-Outs

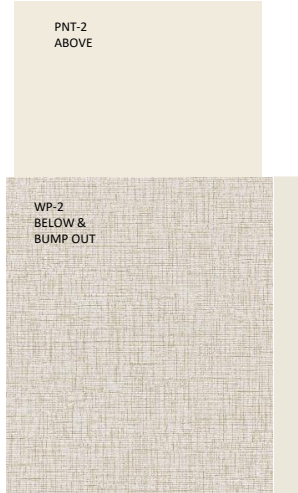

CORRIDOR 400 WING

C
G
-
1



CORRIDOR 300 WING

C
G
-
2



CORRIDOR 500 WING

C
G

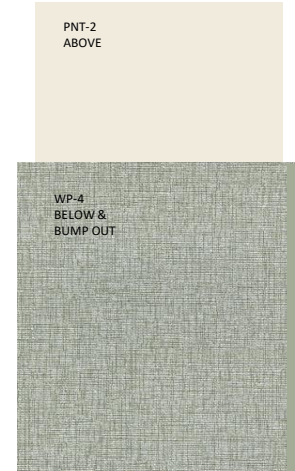

CENTER CORE- ENTRY

C
G

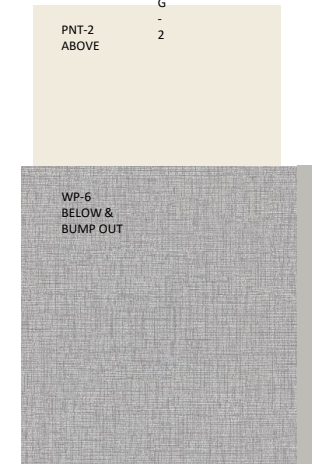

CORRIDOR 200 WING

C
G
-
5

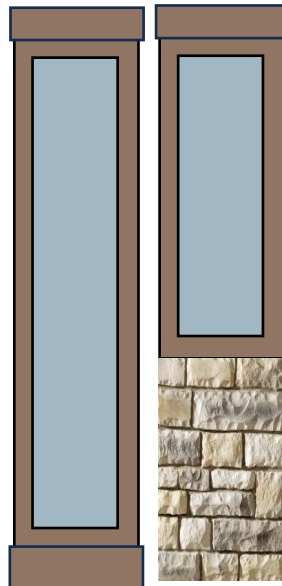

COLUMN IDEAS

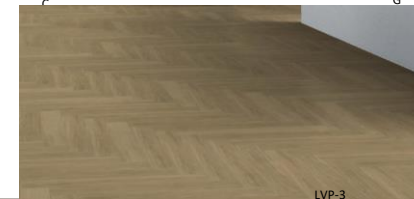

LVP-3



LVP-2



PNT-6 CENTER CORE CEILING ACCENT



Simple Tile Backsplash in Kitchen Area

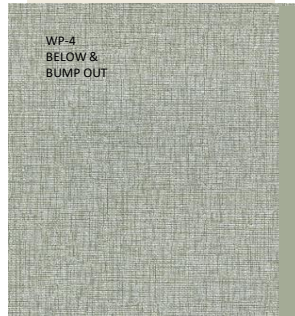
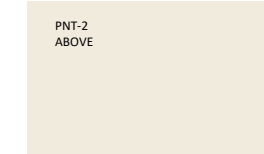

CENTER CORE- ENTRY



C G - 3



Q Z - 1

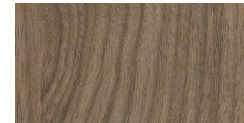

CABINETS / STAIN COLOR



Decorative Tile at Seated Counter Area



HILLVIEW HEALTHCARE CENTER- CBRF AREA B / A.2 35 BEDS + CRISIS 4 BED - LOUNGE 114 , 302, STAFF

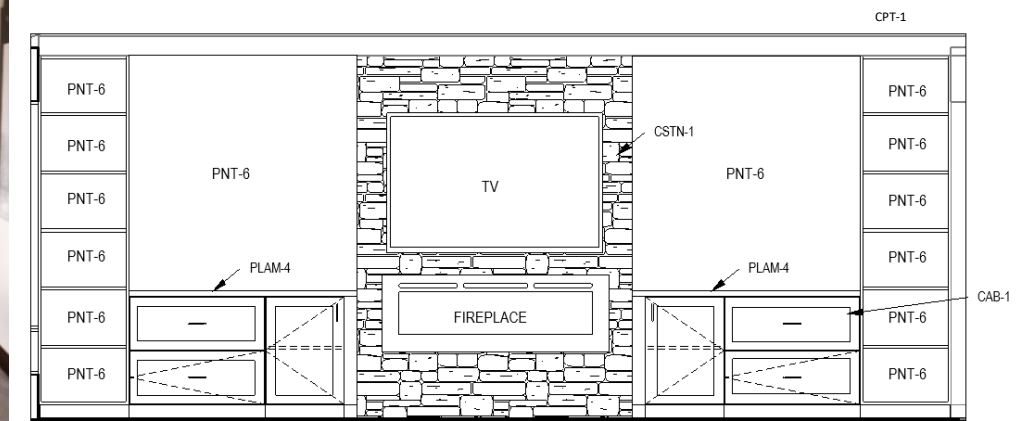
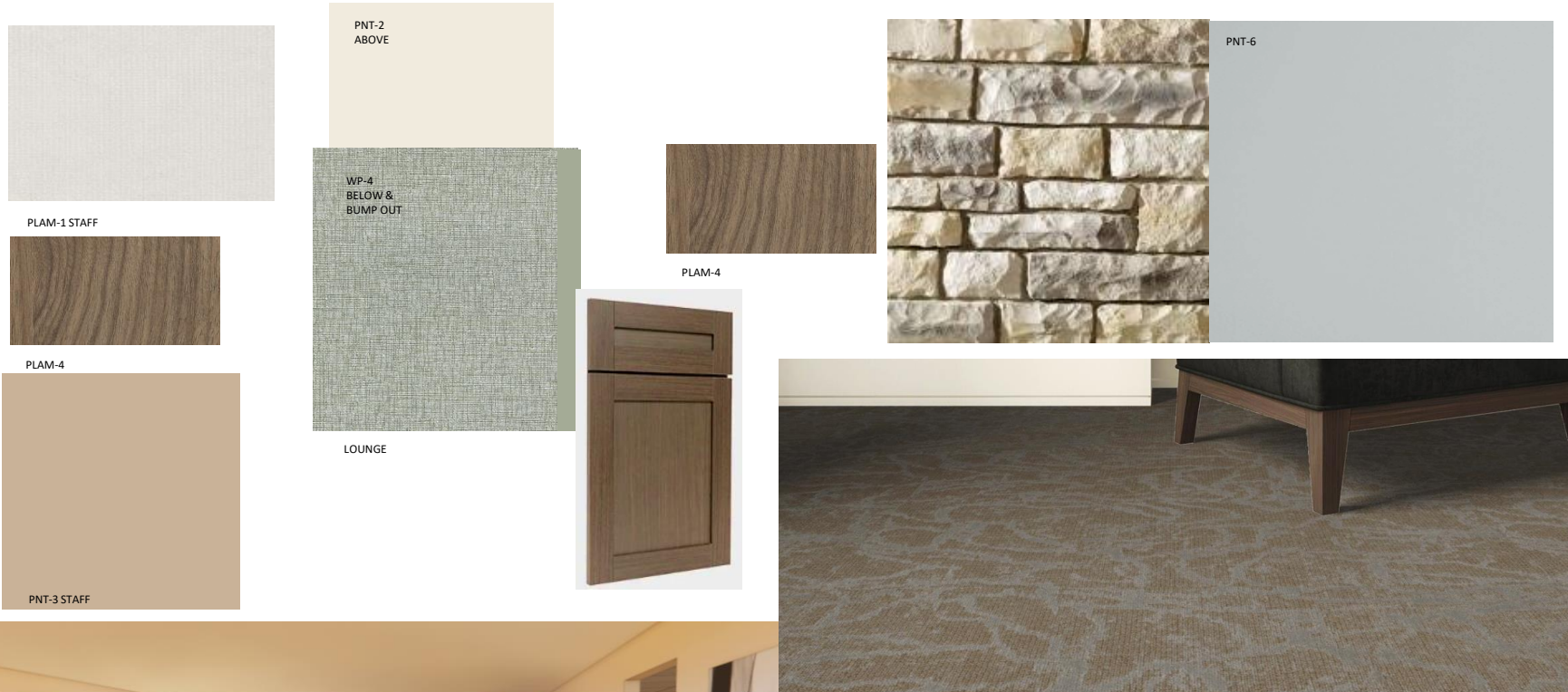

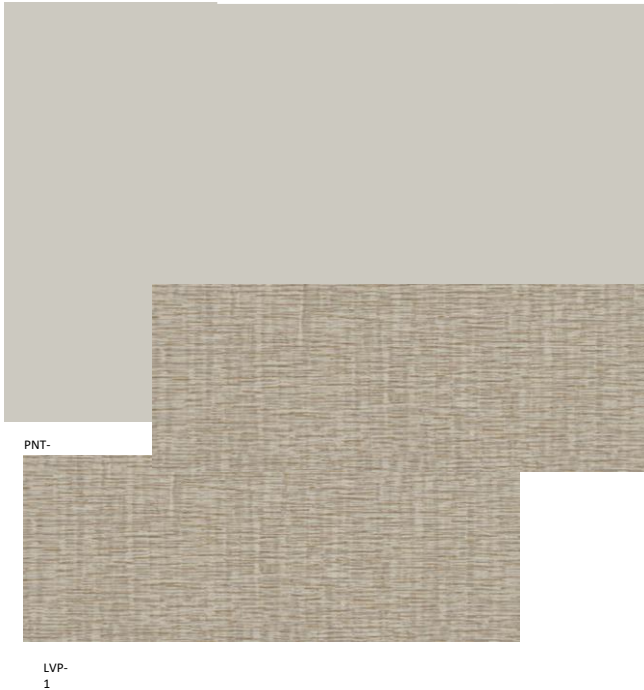

HILLVIEW HEALTHCARE CENTER- CBRF HOUSEHOLD AREA B / A.2 35 BEDS + CRISIS 4 BED - ROOMS



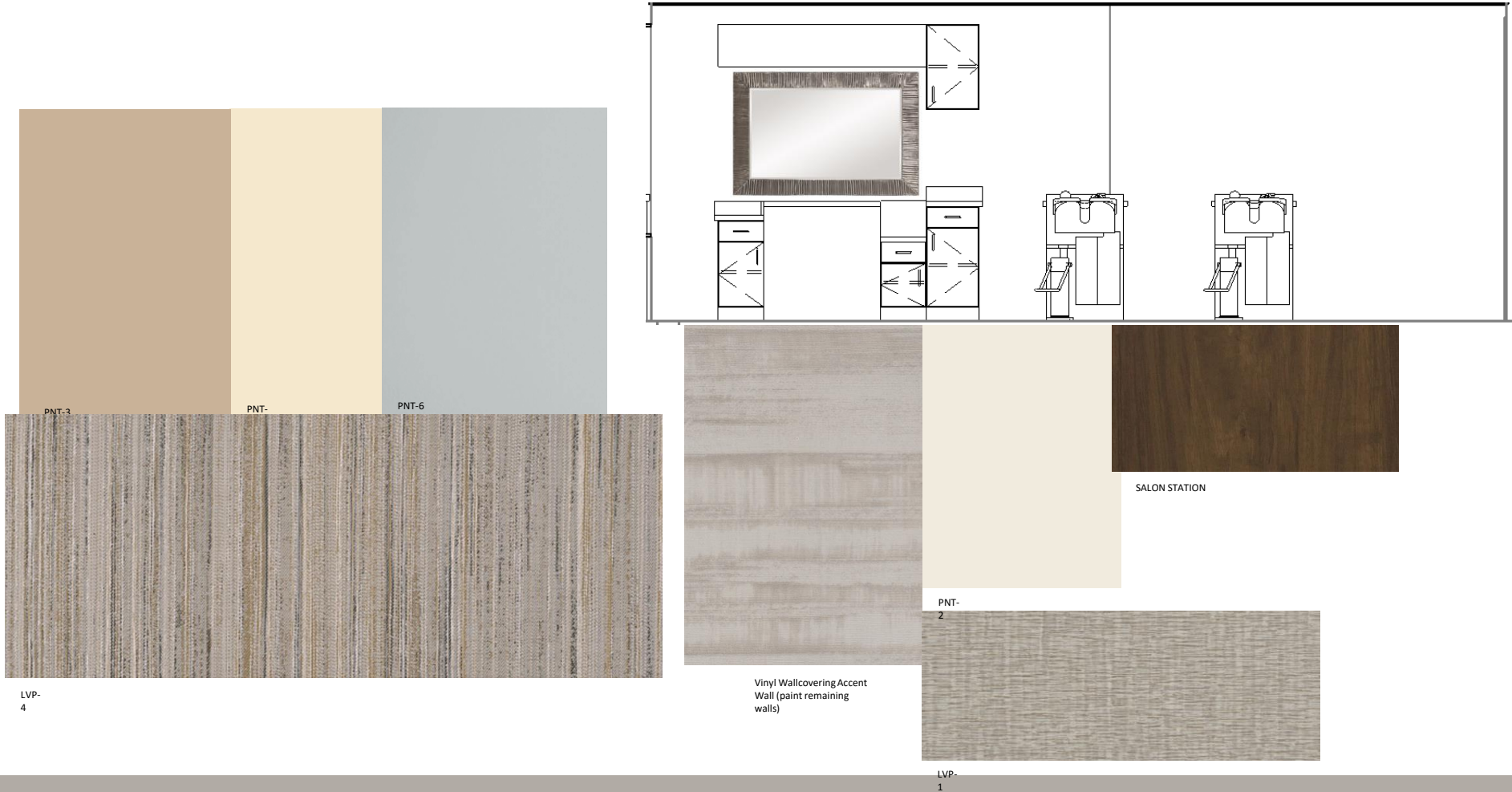



CPT-3

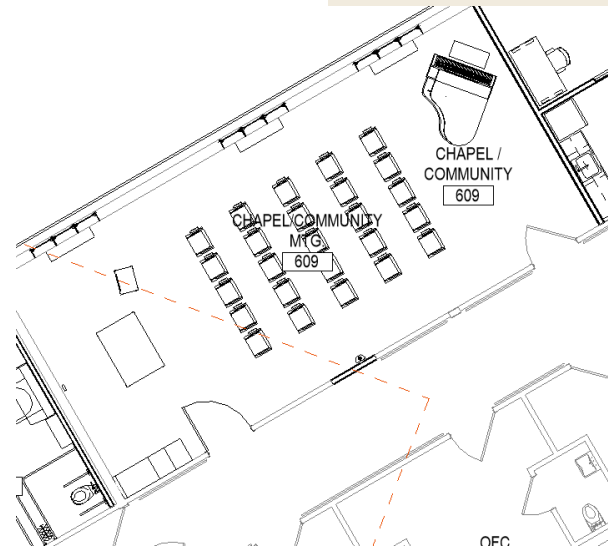
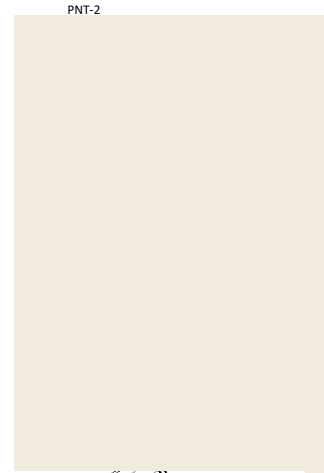

CPT-2



Q
Z
-
2



Simple Tile Backsplash in Kitchen Area



Decorative Tile at Seated Counter Area

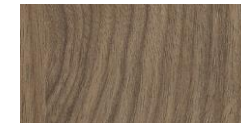

CABINETS / STAIN COLOR

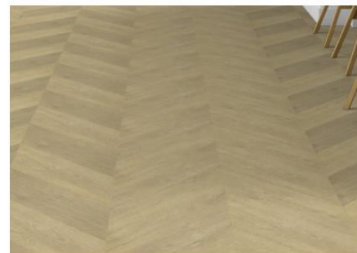

Thank you for
your time today!

Family Meetings

October 16,

May change to monthly as the project gets going.