

# LA CROSSE COUNTY HIGHWAY DEPARTMENT

## PLAN OF PROPOSED IMPROVEMENT

**CTH M**  
(CTH W TO CTH D)

**CTH M**  
(USH 14 TO STH 33)

## CULVERT REPLACEMENTS LA CROSSE COUNTY

### ORDER OF SHEETS

Section No.	1	Title *
Section No.	2	Typical Sections and Details *
Section No.	3	Estimate of Quantities
<del>Section No.</del>	<del>3</del>	<del>Miscellaneous Quantities</del>
<del>Section No.</del>	<del>4</del>	<del>Right of Way Plat</del>
Section No.	5	Plan and Profile
Section No.	6	Standard Detail Drawings (See Project Manual for Standard Detail Drawings)
<del>Section No.</del>	<del>7</del>	<del>Sign Plates</del>
Section No.	8	Structure Plans
<del>Section No.</del>	<del>9</del>	<del>Computer Earthwork Data</del>
Section No.	9	Cross Sections

\* Plan Sheets In These Sections Include Color  
TOTAL SHEETS = 33

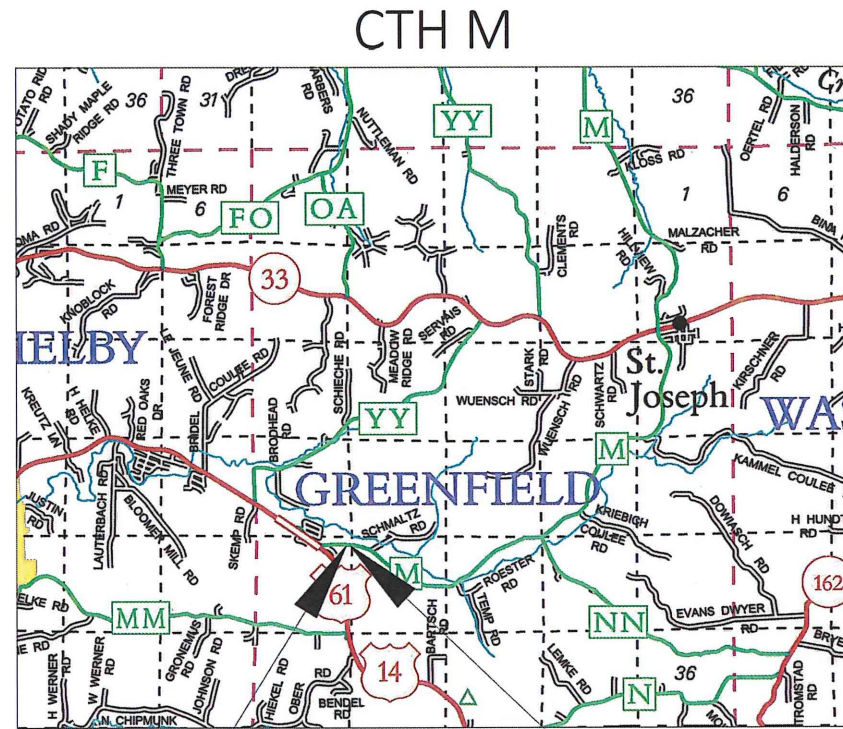
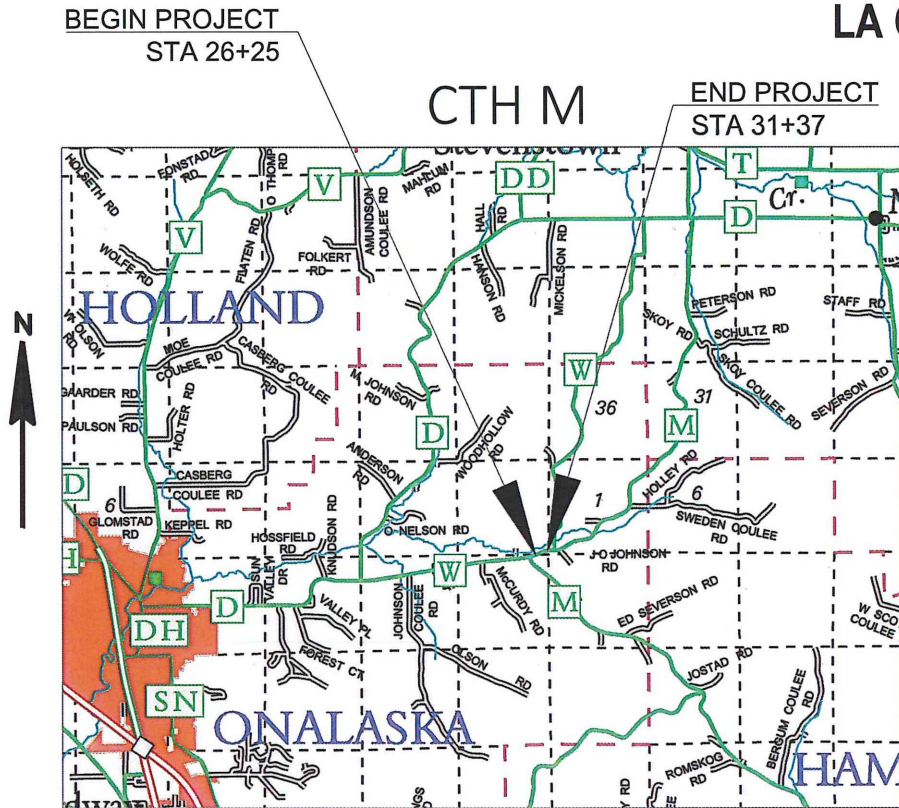

BEGIN PROJECT  
STA 81+50

END PROJECT  
STA 82+65

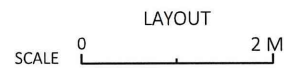

TOTAL NET LENGTH OF CENTERLINE = 0.09 MI (CTH M NORTH)  
0.02 MI (CTH M SOUTH)

### CONVENTIONAL SYMBOLS

PLAN	
CORPORATE LIMITS	
PROPERTY LINE	
LOT LINE	
LIMITED HIGHWAY EASEMENT	
EXISTING RIGHT OF WAY	
PROPOSED OR NEW R/W LINE	
SLOPE INTERCEPT	
REFERENCE LINE	
EXISTING CULVERT	
PROPOSED CULVERT (Box or Pipe)	
COMBUSTIBLE FLUIDS	
MARSH AREA	
WOODED OR SHRUB AREA	

PROFILE	
GRADE LINE	
ORIGINAL GROUND	
MARSH OR ROCK PROFILE (To be noted as such)	
SPECIAL DITCH	
GRADE ELEVATION	
CULVERT (Profile View)	
UTILITIES	
ELECTRIC	
FIBER OPTIC	
GAS	
SANITARY SEWER	
STORM SEWER	
TELEPHONE	
WATER	
UTILITY PEDESTAL	
POWER POLE	
TELEPHONE POLE	

ACCEPTED FOR  
LA CROSSE COUNTY

Date \_\_\_\_\_ County Highway Commissioner

ORIGINAL PLANS PREPARED BY

**origin**  
design

WORKING ON TOMORROW.

800 556-4491  
origindesign.com

**WISCONSIN**  
NOAH J. HOFRICHTER  
E-46240  
DUBUQUE, IOWA  
PROFESSIONAL ENGINEER

DATE: 12/19/2024 *Noah J. Hofrichter*  
(Professional Engineer Signature)

HORIZONTAL POSITIONS SHOWN ON THIS PLAN ARE WISCONSIN COORDINATE REFERENCE SYSTEM (WISCRS), LA CROSSE COUNTY, NAD83 (2011), IN U.S. SURVEY FEET. POSITIONS SHOWN ARE GRID COORDINATES, GRID BEARINGS, AND GRID DISTANCES. GRID DISTANCES ARE THE SAME AS GROUND DISTANCES. ELEVATIONS ARE REFERENCED TO NAVD 88 (2012). GPS DERIVED ELEVATIONS ARE BASED ON GEOID 12A.

PROJECT ID:

COUNTY: LA CROSSE